

REOTEMP INSTRUMENTS Product drawing

THERMOWELL WITH:

- Flanged Process Connection
- Straight Shank

Reotemp Part#: **151R2F-SU170L192-TST2**

Material: **304 Stainless (std)**

Dimensions (inches):

Bore Dia. B:	.260" bore, for 1/4" dia. Element"
Element Length A:	19"
Overall Length L:	19.25"
Insertion Length U:	17"
Lag T:	0"
Process P:	1.5", 150# Raised Face (RF-std)
Shank dia. Q:	.750"

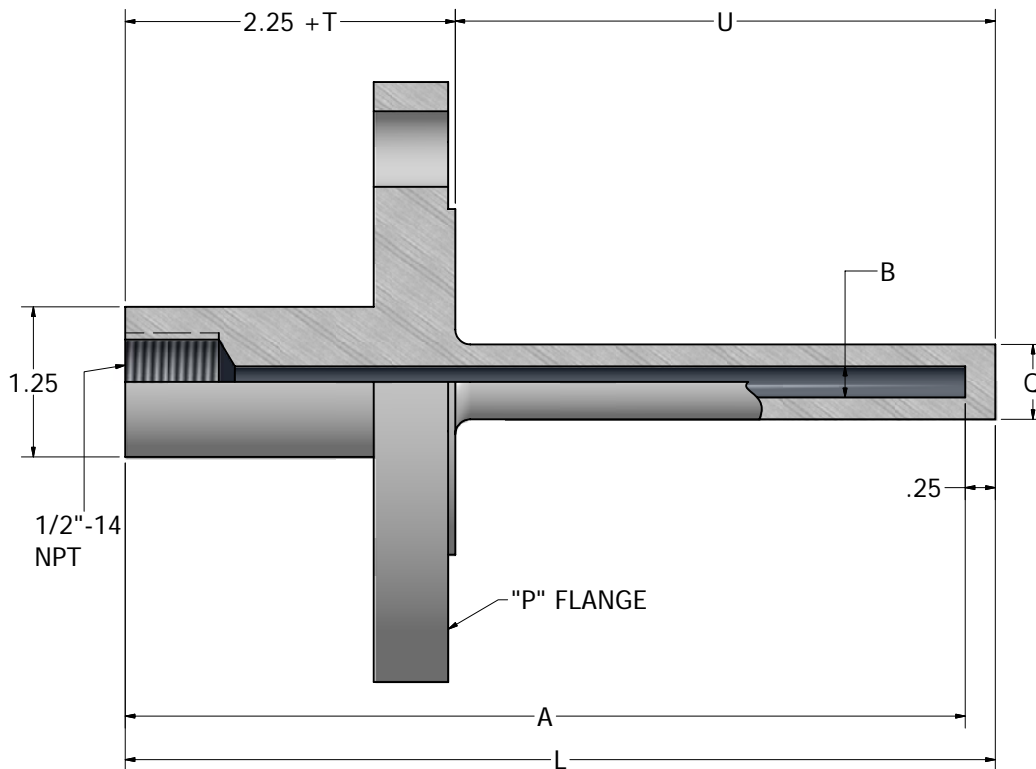

Options included (not depicted in Dwg.)

Option 1:	Stainless Tag (attached -max. 25 chars)
Option 2:	PFA Coating over Wetted (1-2 mils)
Option 3:	
Option 4:	
Option 5:	
Option 6:	
Option 7:	
Option 8:	

Drawing No.: **TWC-FS-151R2F-SU170L192-TST2**

Data production date: 08/07/2025

THIS DRAWING AND SPECIFICATIONS ARE THE PROPERTY OF REOTEMP INSTRUMENT CORP., AND ARE ISSUED IN STRICT CONFIDENCE AND SHALL NOT BE REPRODUCED, COPIED OR USED AS THE BASIS FOR MANUFACTURE OR SALE OF ITEMS DEPICTED HEREIN WITHOUT WRITTEN PERMISSION FROM REOTEMP INSTRUMENT CORP.

NOTES (UNLESS OTHERWISE SPECIFIED)

- 1) DIMENSIONS ARE IN INCHES
- 2) DIMENSIONS ARE SUBJECT TO CHANGE. FINAL DIMENSIONAL VERIFICATION CAN BE REQUESTED AT TIME OF ORDER.

REVISIONS			
REV	DESCRIPTION	DATE	APPROVED
X1	INITIAL RELEASE	5/14/10	MO

PART NAME THERMOWELL, FLANGED, STRAIGHT SHANK				
UNLESS OTHERWISE SPECIFIED DIMENSIONS ARE IN INCHES TOLERANCES ARE:		REOTEMP Instrument Corporation 10656 Roselle Street San Diego, CA 92121 USA Phone: (858) 784-0710 Fax: (858) 784-07-20		DATE 5/14/10
				DRAWN BY JHRichter
PART NO SEE CHART	SIZE C	CAGE CODE 24793	BASE DWG NO TWC-FS	REV X1
FIRST USED ON	SCALE: NTS	FILE NAME: CF	SHEET 1 OF 1	